

Alco-Safe and Lion have taken customer feedback and created the AlcoBlow® Rapid Test, **ENCLOSURE** to minimise the risk of COVID 19 infection. *No disposable mouthpieces are required.* The subject simply blows into a straw at the end of the encased instrument.

*There is no physical contact with the subject, **SO NO MOUTHPIECES ARE NEEDED!***

HANDS FREE, SOCIAL DISTANCING, NO CONTACT, SAFE BREATHALYSER TESTING

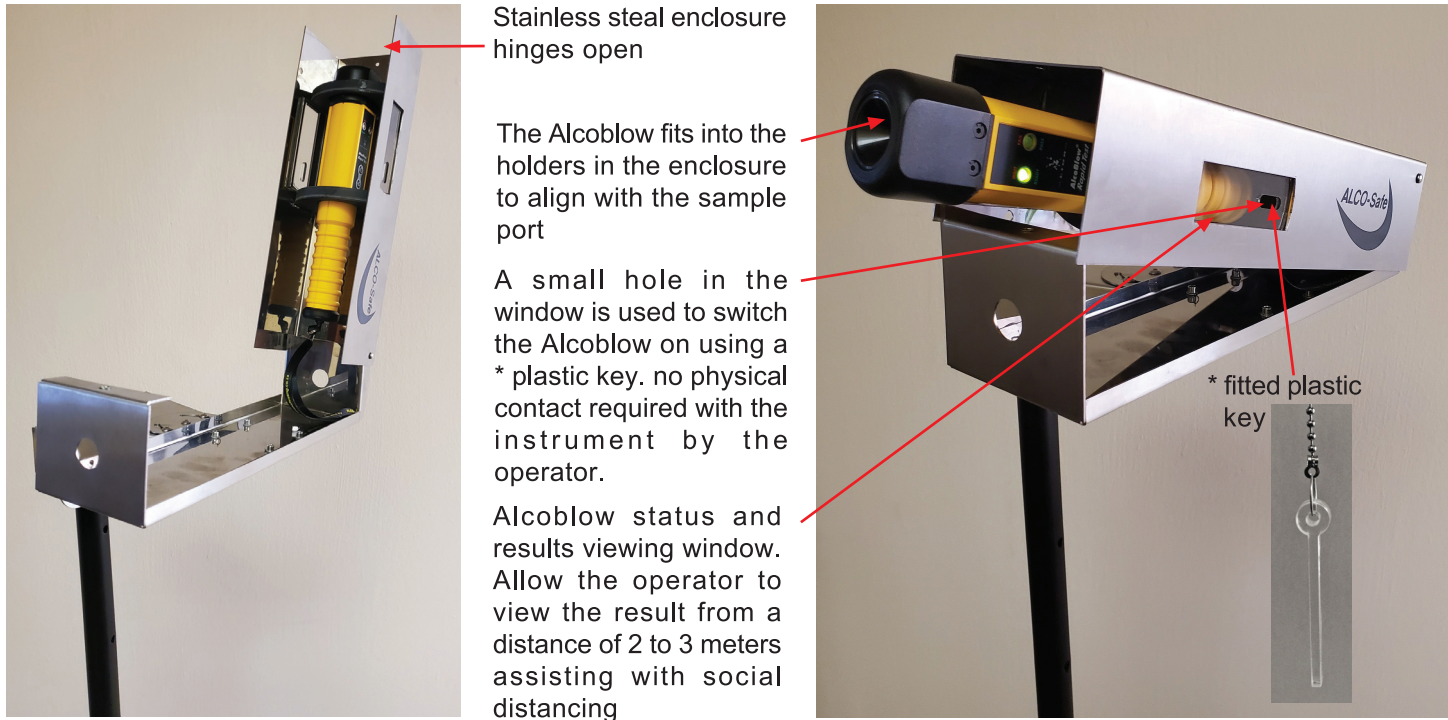

Stainless steel enclosure hinges open

The Alcoblow fits into the holders in the enclosure to align with the sample port

A small hole in the window is used to switch the Alcoblow on using a * plastic key. no physical contact required with the instrument by the operator.

Alcoblow status and results viewing window. Allow the operator to view the result from a distance of 2 to 3 meters assisting with social distancing

* fitted plastic key



Blowing with a straw means no contact with the Alcoblow and quick test samples first time every-time



The enclosure can be supplied with a tripod or standalone where it can be mounted to a wall or gate

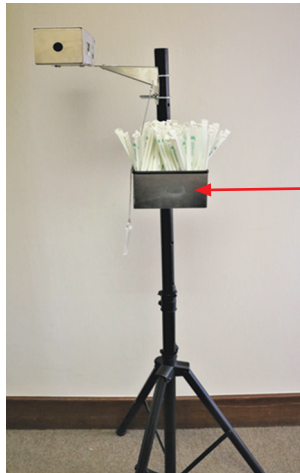

Stainless steel straw holder can hold up to 300 straws and can be fitted to a wall, gate or the tripod

